

In last newsletter regarding the contest there was a mistake: your essay has to be 3,000 and 5,000 CHARACTERS long (not words). Sorry for this mistake. Check also our www page (www.forum-leaders.eu) for terms&conditions of the contest.

PLEASE REMEMBER TO HAVE OUR APPLICATION DOWNLOADED AND REGISTER FOR THE WORKSHOPS/MOBILE CENTRE IF YOU HAVE NOT DONE IT YET! ALL THE NECESSARY NEWS AND CHANGES IN AGENDA WILL BE UPLOADED THERE!!!

Remember that you still have the opportunity to take part in workshops organized in Mobile Erasmus+ Center! Use our mobile application to do the registration. Go to Agenda -> Mon 3 Sep 2018 -> and choose one of four available groups. This workshop will take place in the truck at the main square of Nowy Sącz. Don't miss it!



Please, read this newsletter carefully
till the end. It is very important that you know everything
what is written here before you ask our staff any question.



Please, remember to inform us **if you are going to come on 3rd Sept after 9 pm or on 4th Sept in the morning**. People who come on Monday, 3rd late will be informed earlier about their hotels and go straight there to sleep. They will be given their ID cards and issues on Tuesday in the morning (as the participants who will come on 4th Sept). The rest will get to know about the accommodation at the reception desk while being given the ID cards.

Remember! If you do not inform us that you come late on Monday or on Tuesday morning, it may pose a problem with your accommodation!!!

Short FAQ

Can I come to Nowy Sącz earlier than 2nd Sept or leave later than 7th Sept?

Of course you can. BUT note that we provide the accommodation only during the Forum, so between 3rd and 7th Sept. On any other day, you have to find a room on your own. You can check in the hotels we chose for you - their list is to find [here](#).

Where will I stay for night?

Do not worry. If you come on 3rd Sept between 10 am and 9 pm - you will get to know your hotel at the reception. In any other case - please contact us.

The list of hotels, as well as the most relevant info about travelling etc. is to find [here](#) .

How should I travel to Nowy Sącz from...?

As you travel from many cities and countries, it is



hard to answer this question. The most popular routes are Warsaw - Nowy Sącz and Cracow - Nowy Sącz. About them you can read [here](#). There is a list of the most convenient buses to Nowy Sącz.

We do not recommend you to travel by train. As for the travel from other cities (e.g. Katowice), please, try to use [Flixbus](#) or another big bus company.

Yay, I managed to come to Nowy Sącz!
Where should I go now and how?

We will meet in **WYŻSZA SZKOŁA BIZNESU - NATIONAL-LOUIS UNIVERSITY**, Zielona 27 street, 33-300 Nowy Sącz.

The whole Forum will be held there (apart from Krynica day).

You can go there by bus: numbers **3,11,12,17,24,43,49** will take you straight to WSB.

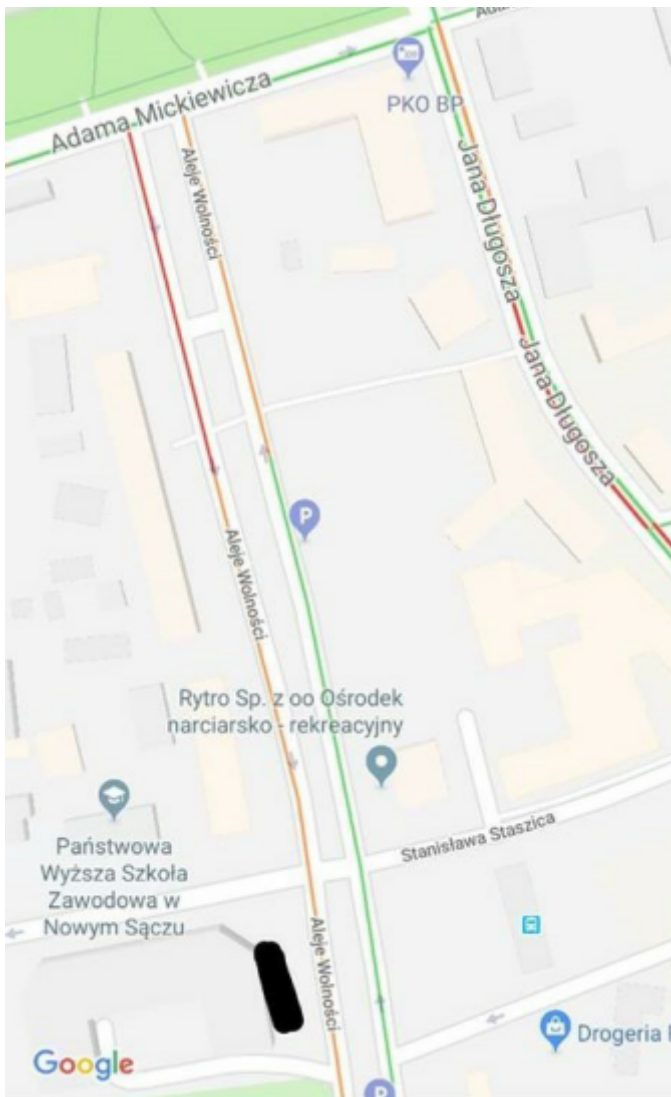

The black rectangle marks the bus stop where you have to catch the bus to the registration place.

We recommend you to use the **[jakdojade](#)** application. It is very useful when staying in Nowy Sącz and in other Polish cities. You can also use it via page

https://jakdojade.pl/nowy_sacz/tras

In both cases you have to write the name of the street where you are and the name of the street/place you wanna go to. The app will search for the most convenient way of communication. You can also use GoogleMaps.

I don't like buses.

You can always go to WSB-NLU by taxi.

18 444 44 44 – Taxi Nowy Sącz

**18 533 33 33 - Radio Taxi Nowy Sącz
"Trójki"**

18 444 10 00 - Radio Taxi Galicja

**The price of the route Dworzec PKS -
WSB NLU is about 12-16 zlotys.**



Can I say something during the debates?

Yes. In the agenda you can send a question that can be posed during the debate (the moderator will choose the questions, remember that not every of them will be read during the meetings!). Do it via your app **ONLY TILL 3rd SEPT, 8 pm!!!**

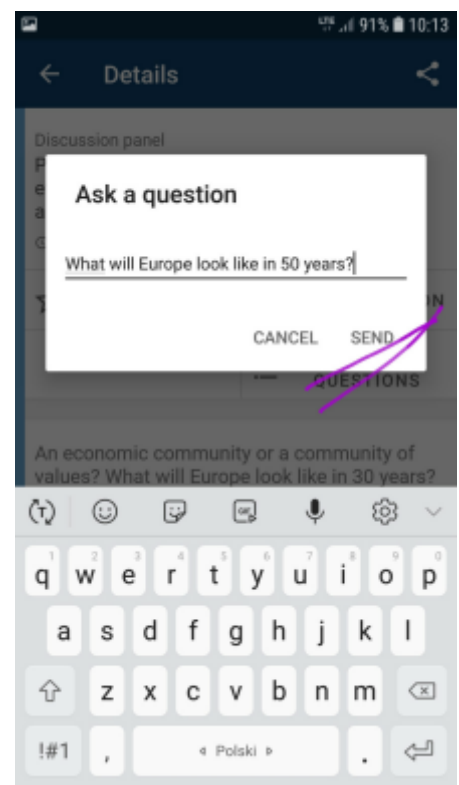
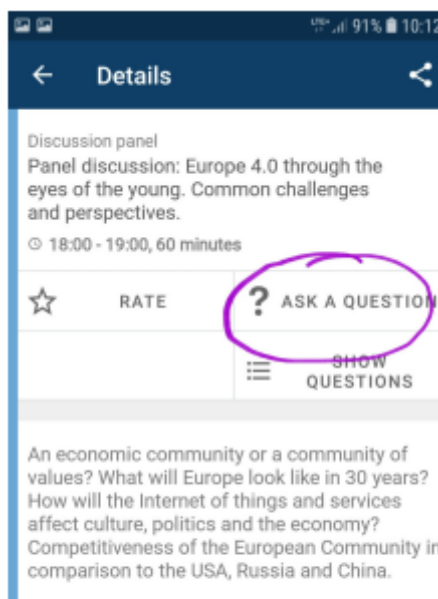
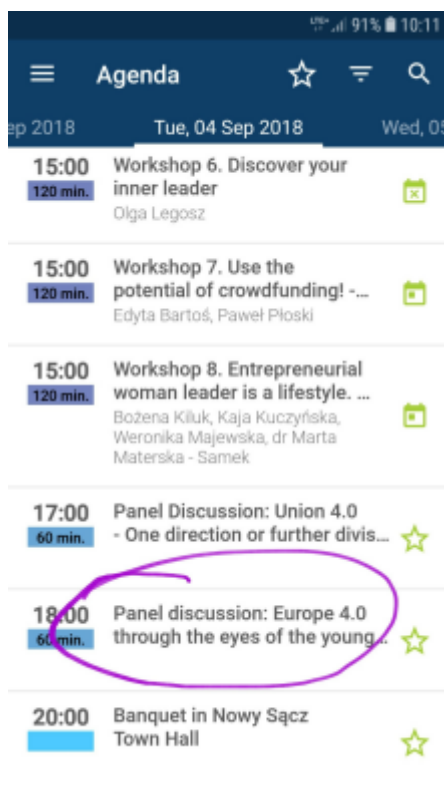

**When&how will I get travel
costs reimbursement for
foreigners?**

**Honestly, I don't know. :)
Nowy Staw Foundation does not deal with**

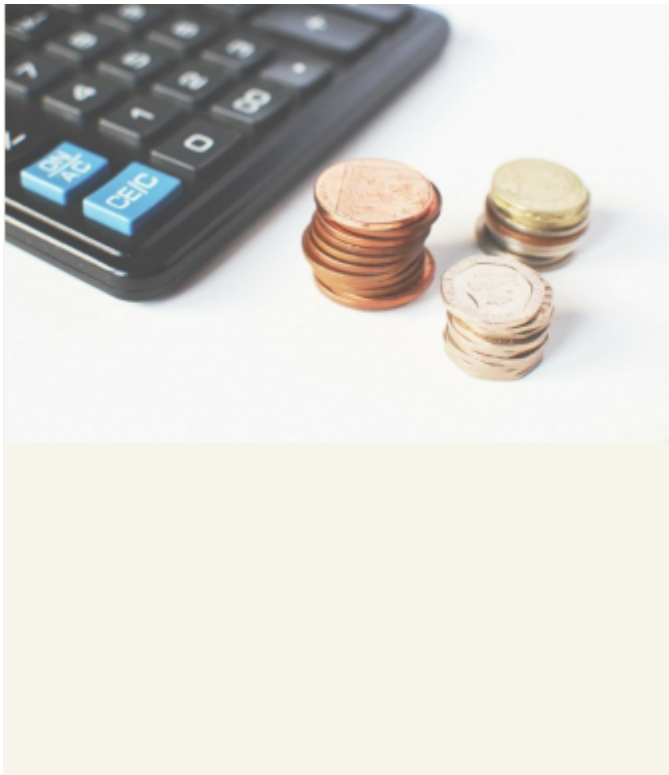

reimbursement procedures. For this stuff, please ask **Ms Melania Miksiewicz from FRSE.**

Please do not ask anyone else about this issue, just her.

e-mail: mmiksiewicz@frse.org.pl
phone: +48 22 64 31 422

The reimbursement will be transferred **on your bank account number of which you should give to Mrs Melania.** She also sent you an e-mail with the document about travel costs refundation.

On 4th and 5th Sept, next to the reception, you will be able to get the extra news about the reimbursement and - probably - get the paper version of the document letting you get the reimbursement. **There is no option to get the money on place ('hand-to-hand') - we provide it only by bank transfers.**



Any questions?

Anna Pietron

European Meeting Centre -Nowy Staw Foundation
ul. Zana 38
20-601 Lublin
phone no: +48 507 112 228
forum@forum-leaders.eu

Let's stay in touch



**nationale
nederlanden**



Nationale - Nederlanden is the
Official Recruitment Partner of
the Forum 2018

Coca-Cola is the Strategic
Partner of the Forum 2018

Małopolska Region is the Main
Partner of the Forum 2018

We hope you like our newsletters. If not, you can [unsubscribe here](#).